

STC	API-225M	API-230M	API-235M	API-240M	API-245M
Nominal peak power	225W	230W	235W	240W	245W
Open circuit voltage	37.1V	37.3V	37.5V	37.7V	37.8V
Max. power voltage	29.3V	29.7V	30.1V	30.4V	30.8V
Short circuit current	8.20A	8.27A	8.33A	8.45A	8.55A
Max. power current	7.68A	7.75A	7.81A	7.90A	7.96A
module efficiency	13.8%	14.1%	14.4%	14.7%	15.0%
Power output tolerances	±3%				
Max. system voltage	600 VDC				
Max.series fuse rating	15A				
Operating temperature	- 40°C to + 85°C				

\*Electrical parameters at STC (1,000 W/m<sup>2</sup>, 25°C, AM 1.5 according to EN 60904-3)

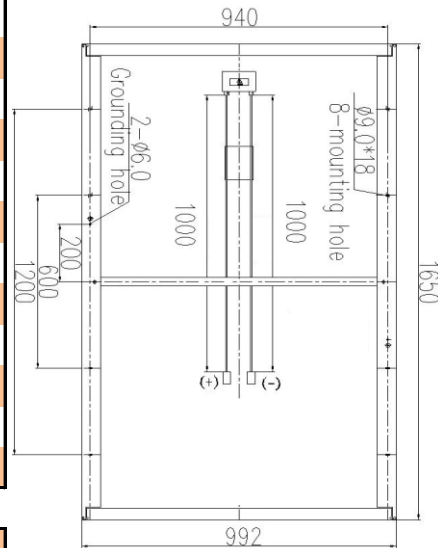

NOCT	API-225M	API-230M	API-235M	API-240M	API-245M
Nominal peak power	160W	164W	168W	171W	175W
Open circuit voltage	33.8V	33.9V	34.1V	34.3V	34.4V
Max. power voltage	25.8V	26.1V	26.5V	26.8V	27.1V
Short circuit current	6.64A	6.70A	6.75A	6.84A	6.93A
Max. power current	6.22A	6.28A	6.33A	6.40A	6.45A
NOCT	46°C±2°C				

\*Electrical parameters at NOCT (800 W/m<sup>2</sup>, 20°C, AM 1.5 according to EN 60904-3)

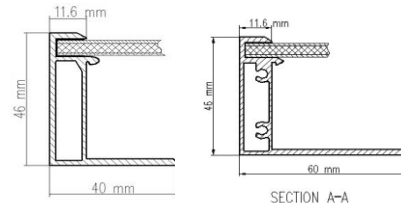

SECTION B-B

Temperature coefficients	
γ <sub>Pm</sub>	-0.47%/K
α <sub>sc</sub>	0.056%/K
β <sub>Voc</sub>	-0.34%/K

Mechanical parameters	
Module dimension	1650*992*46(mm)
Weight	23.0kg
Max. wind Load	2400pa
Max. snow Load	5400pa
Cell dimension	156*156
Cell type	60(6*10) / Monocrystalline
Packing method	546pcs/40'HC 390pcs/40'

Current, power VS voltage characteristics  
(solar irradiant: 100%, 80%, 50%)

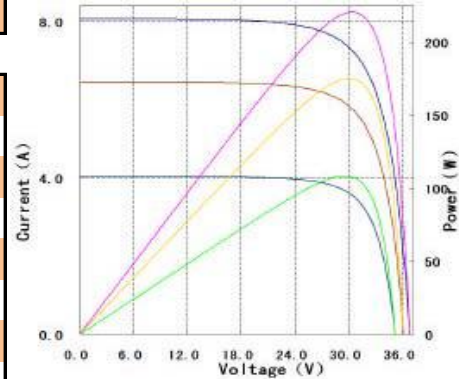

**Advance Solar, Hydro, Wind Power Co., Inc.** Since 1978

6331 N. State Street, Redwood Valley, CA 95470, USA

(Toll Free) 1.888.228.9694, or 707.485.0588

[www.advancepower.net](http://www.advancepower.net)